

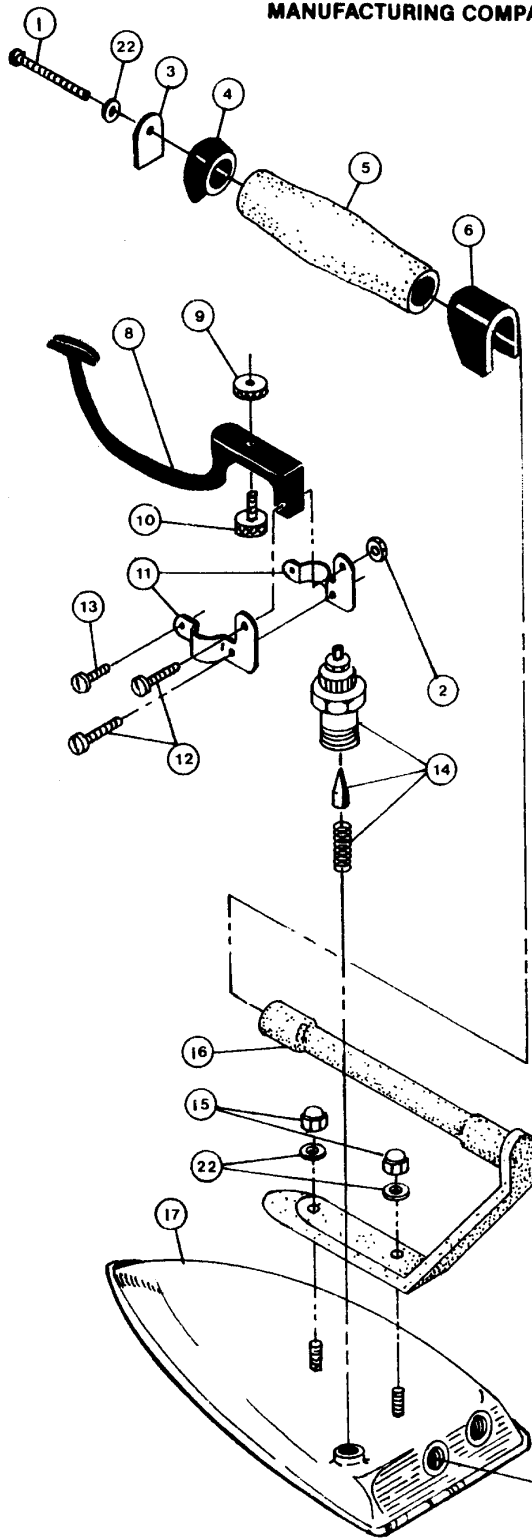

831 South First St.
P.O. Box 32270
Louisville, KY
40232-2270
502/587-1292
Pacific Coast Office:
4823 West Jefferson Blvd.
Los Angeles, CA 90016
213/731-2196

Foreign Distributors
write Export Dept.,
Cable Code Cissell
Telex No. 204158
European Headquarters:
Pantex-Cissell B.V.
P.O. Box 53, 9670 AB
Winschoten, Holland
Telex No. 53535



CISSELL ALL STEAM IRON

<u>Ref. No.</u>	<u>Part No.</u>	<u>Description</u>
1	X345	Handle Bolt
2	X363	4mm Hex Nut
3	X58	Front Handle Plate
4	X54	Front Handle End
5	X56	Cork Grip W/Core
6	X346	Rear Handle End
8	X348	Thumb Lever
9	X349	Lock Nut Adjust Screw
10	X350	Adjusting Screw
11	X351	Bracket Set
12	X352	Pan Hd. Screw - 18 mm lg. (2 req'd)
13	X353	Pan Hd. Screw 8mm Lg.
14	X354	Steam Mist Valve, Plunger & Spring
15	X355	Crown Nut (2 req'd.)
16	X356	Handle Support
17	X357	All Steam Sole Plate
18	X358	Control Valve,Handle,Screw
19	X359	Hose w/couplings
20	X360	Control Valve Handle
21	X361	Handle Screw
22	X362	Washer(3 req'd.)
23	X370	Iron Coupling Only
24	X369	Hose Coupling Only

MAN187
4-87 2M
B&K

AristoCraft, Inc. provides the information contained herein in good faith but makes no representation as to its comprehensiveness or accuracy. This document is intended only as a guide to the appropriate precautionary handling of the material by a properly trained person using this product. Individuals receiving the information must exercise their independent judgement in determining its appropriateness for a particular purpose. ARISTOCRAFT, INC. MAKES NO REPRESENTATIONS OR WARRANTIES, EITHER EXPRESS OR IMPLIED, INCLUDING WITHOUT LIMITATION ANY WARRANTIES OF MERCHANTABILITY, FITNESS FOR A PARTICULAR PURPOSE WITH RESPECT TO THE INFORMATION SET FORTH HEREIN OR THE PRODUCT TO WHICH THE INFORMATION REFERS. ACCORDINGLY, ARISTOCRAFT, INC. WILL NOT BE RESPONSIBLE FOR DAMAGES RESULTING FROM USE OF OR RELIANCE UPON THIS INFORMATION.